



# Electronic semi-parallel ignitor for HID lamp circuits

## SN 56

HID ignitors for semi-parallel systems

### Product data

General Information	
Application Code	56
Operating and Electrical	
Input Voltage	220 to 240 V
Input Frequency	50 to 60 Hz
Igniton Type	Semi-Parallel
Ignition Voltage (Max)	5.0 kV
Ignition Voltage (Min)	2.8 kV
Response Voltage	196 V
Mains Voltage Performance (AC)	-8%+6%
Mains Voltage Safety (AC)	-10%+10%
Power Losses (Nom)	1.5 W
Wiring	
Ballast Contact Wire Cross Section	0.50-2.50 mm <sup>2</sup>
Connector Type	Screw
Temperature	
T-Ambient (Max)	55 °C

T-Ambient (Min)	-20 °C
T-Case Maximum (Max)	60 °C
Mechanical and Housing	
Housing	Akulon S223
Approval and Application	
Approval Marks	CE marking
Product Data	
Full product code	697013372885700
Order product name	SN 56
EAN/UPC - Product	6970133728857
Order code	913710010713
Numerator - Quantity Per Pack	1
Numerator - Packs per outer box	20
Material Nr. (12NC)	913710010713
Net Weight (Piece)	0.079 kg

## Electronic semi-parallel ignitor for HID lamp circuits

### Dimensional drawing

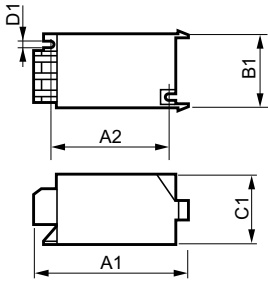

Product	C1	A1	A2	B1
SN 56	38.5 mm	114.5 mm	95.0 mm	41.5 mm

SN 56

